

SITE & PAVING PLAN NOTES

- 1 DO NOT DAMAGE EXISTING ADJACENT SEPTIC SYSTEM, TANK OR BED, WHEN PREPARING SUB GRADE FOR CONCRETE PAVED PATIO.
- 2 REMOVE ORGANIC MATERIAL & LOOSE SOIL FROM AREA TO RECEIVE CONCRETE PAVING.
- 3 PREPARE SUB-GRADE & FORM-WORK & COMPACT TO 98% SPMD WITH MIN. 8" OF GRANULAR "A" AT TOP OF PREPARED BASE, & GRANULAR "B" BENEATH AS REQUIRED.
- 4 POUR CONCRETE PAVING MIN. 6" THICK & WITH CROSS SLOPE OF 1% AWAY FROM BUILDING.
- 5 SEE CONCRETE PAVING PLAN FOR EXPANSION JOINT (EJ) & CONTROL JOINT (CJ) LOCATIONS. REVIEW LAYOUT WITH ARCHITECT PRIOR TO POURING CONCRETE PAVING.
- 6 FINISH WITH NON-SLIP TEXTURE MATCHING EXISTING PAVING TO REMAIN. FINISH EDGES TO MATCH CONCRETE PAVING TO REMAIN.

148 WALTON STREET, PORT HOPE, ONTARIO L1A 1N6, CANADA
TEL: (905) 885-8729 www.picciniarchitect.net

THESE DRAWINGS, DETAILS AND SPECIFICATIONS ARE A CONFIDENTIAL AND PROPRIETARY WORK PROTECTED UNDER COPYRIGHT. ALL RIGHTS ARE RESERVED. THEY ARE THE PROPERTY OF PICCINI ARCHITECT AND MAY NOT BE REPRODUCED BY ANY MEANS, ALTERED OR RE-USED WITHOUT THE EXPRESS WRITTEN PERMISSION OF PICCINI ARCHITECT

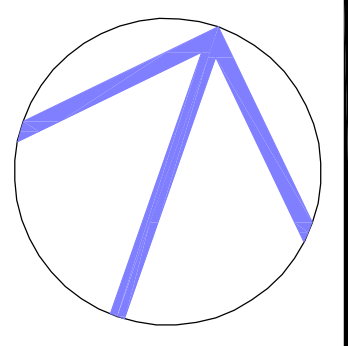

THESE DRAWINGS, DETAILS AND SPECIFICATIONS ARE NOT TO BE USED FOR CONSTRUCTION UNTIL COUNTER-SIGNED BY THE ARCHITECT

NO.	DATE	ISSUE/REVISION FOR:	BY:
	D.M.Y.		
1	07.06.19	CLIENT REVIEW	R.P.
2	14.01.20	CLIENT REVIEW	R.P.
3	13.02.20	BUILDING PERMIT	R.P.
4	25.03.20	BUILDING PERMIT	R.P.
5	14.05.20	TENDER	R.P.

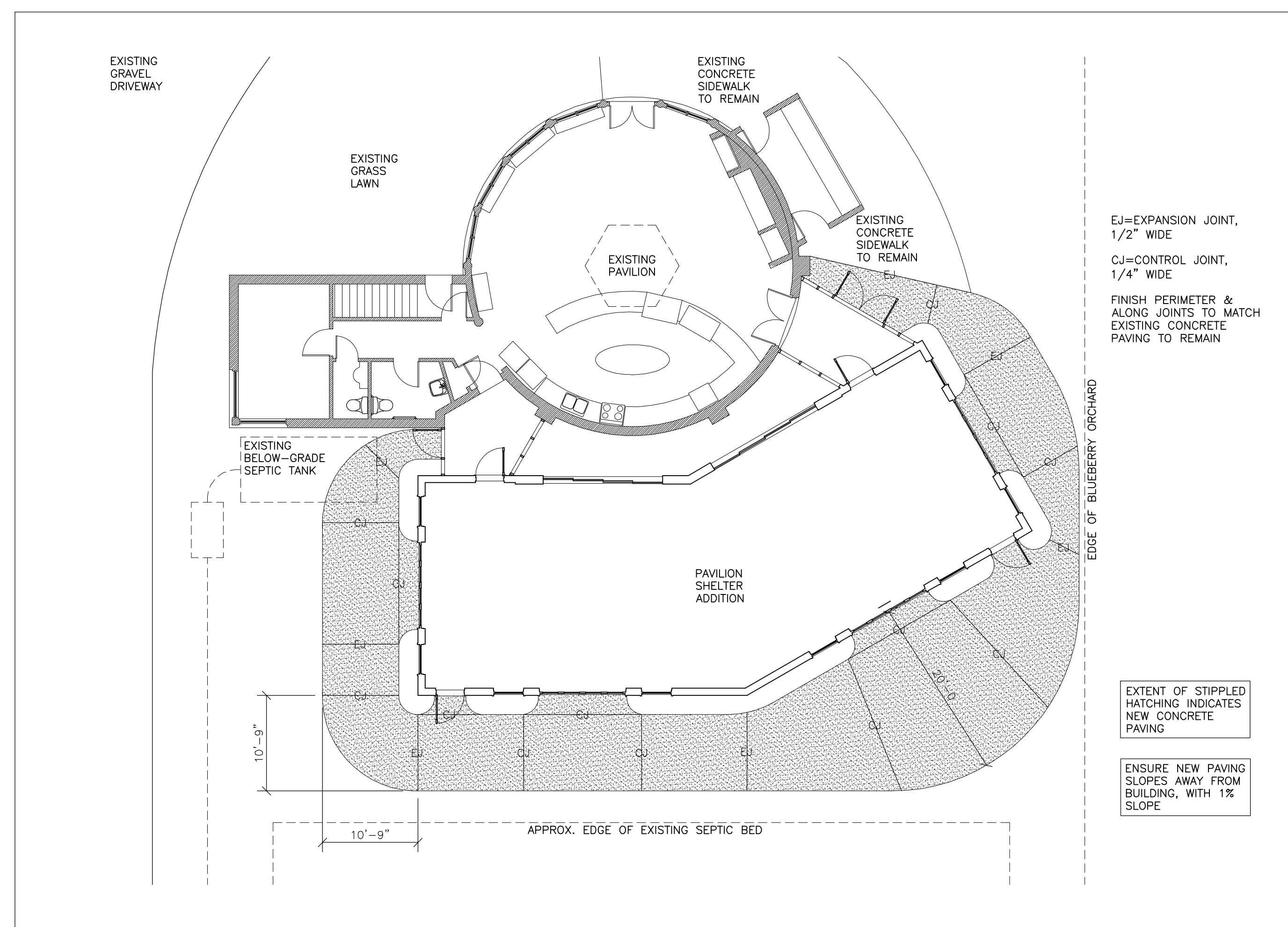

1 SITE PLAN
A101 SCALE: 1"=40'-0"

2 CONCRETE PAVING PLAN
A101 SCALE: 1"=10'-0"

ADDITION TO THE BLUEBERRY PAVILION

WILMOT ORCHARDS
3377 CONCESSION ROAD 3
CLARINGTON, ON L1B 0N1

SHEET TITLE:
SITE PLAN & CONCRETE PAVING PLAN

DRAWN BY: RP	CHK'D BY: RP
PROJECT NO: 19.316	DATE: MAY 2019

A101



148 WALTON STREET, PORT HOPE, ONTARIO L1A 1N6, CANADA
TEL: (905) 885-8729 www.picciniarchitect.net

THESE DRAWINGS, DETAILS AND SPECIFICATIONS ARE A CONFIDENTIAL AND PROPRIETARY WORK PROTECTED UNDER COPYRIGHT. ALL RIGHTS ARE RESERVED. THEY ARE THE PROPERTY OF PICCINI ARCHITECT AND MAY NOT BE REPRODUCED BY ANY MEANS, ALTERED OR RE-USED WITHOUT THE EXPRESS WRITTEN PERMISSION OF PICCINI ARCHITECT

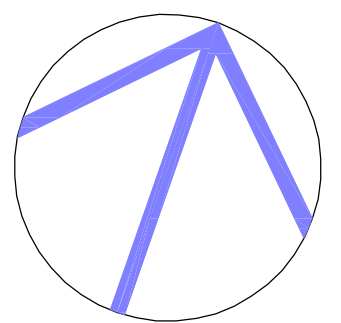

THESE DRAWINGS, DETAILS AND SPECIFICATIONS ARE NOT TO BE USED FOR CONSTRUCTION UNTIL COUNTER-SIGNED BY THE ARCHITECT

NO.	DATE	ISSUE/REVISION FOR:	BY:
	D.M.Y.		
1	25.11.19	CLIENT REVIEW	R.P.
2	14.01.20	CLIENT REVIEW	R.P.
3	13.02.20	BUILDING PERMIT	R.P.
4	14.05.20	TENDER	R.P.

FLOOR PLAN NOTES

- SUPPLY & INSTALL MATERIALS & FINISHES SHOWN ON FLOOR PLAN, UNLESS NOTED OTHERWISE.
 - FOR DOOR & DOOR FRAME, FINISHES, REFER TO DOOR SCHEDULE, OR AS OTHERWISE NOTED ON ELEVATIONS.
 - PROVIDE BASEBOARDS & CASINGS IN PROFILES SPECIFIED, OR AS SHOWN ON DRAWINGS.
 - PROVIDE CONTINUOUS BASEBOARD ALONG FULL PERIMETER OF WALLS, MITER BASEBOARDS, CASINGS & OTHER TRIM AT CORNERS, UNLESS NOTED OR DETAILED OTHERWISE.
 - VERIFY CONDITION OF EXISTING SUBSTRATES PRIOR TO COMMENCING APPLICATION OF FINISHES. NOTIFY ARCHITECT IF SUBSTRATES ARE NOT SUITABLE.
 - SUBMIT SAMPLES OF FINISHES FOR APPROVAL PRIOR TO COMMENCING WORK. SUBMIT CLEAR FINISH SAMPLES ON SAME WOOD SPECIES AS THAT TO WHICH FINISH IS REQUIRED TO BE APPLIED.
 - APPLY INTERIOR FINISHES IN STRICT COMPLIANCE WITH FINISH MANUFACTURER'S INSTRUCTIONS.
- ELECTRICAL**
- PERFORM WORK IN ACCORDANCE WITH ELECTRICAL SAFETY CODE, CURRENT EDITION, BASED UPON CANADIAN ELECTRICAL CODE, PART 1, CSA STANDARD C22.1 & ALL BULLETINS ISSUED TO DATE.
 - OBTAIN ESA INSTALLATION PERMIT PRIOR TO COMMENCING WORK ON SITE, & ARRANGE FOR ESA INSPECTIONS OF WORK.
 - PROVIDE CSA APPROVED MATERIALS ONLY.
 - PROVIDE RECEPTACLES IN LOCATIONS SHOWN ON PLAN & IN ACCORDANCE WITH CODE REQUIREMENTS. COORDINATE LOCATIONS WITH OWNER'S REQUIREMENTS.
 - ALL DEVICES & FACE PLATES ARE TO BE IN "DECORA" STYLE, COLOUR TO BE SELECTED BY OWNER.
 - WALL-MOUNT RECEPTACLES 12" ABOVE FINISHED FLOOR. WHEN GROUPING DEVICES, ENSURE EQUAL SPACING VERTICALLY & AN EVEN LINE HORIZONTALLY. GANG BOXES & COVER PLATES WHERE POSSIBLE.
 - PERFORM TESTING OF SYSTEMS AS REQUIRED BY CODE. AT COMPLETION OF WORK, FORWARD COPY OF ESA CERTIFICATES OF ACCEPTANCE TO ARCHITECT.

LINTEL SCHEDULE

KEY	NO.	SIZE mm OR IMPERIAL	ACTUAL	NOMINAL SIZE
WOOD BUILT-UP LINTELS				
L1	2	38x89mm	1 1/2"x3 1/2"	2x4
L2	2	38x140mm	1 1/2"x5 1/2"	2x6
L3	3	38x184mm	1 1/2"x7 1/4"	2x8
L4	2	38x286mm	1 1/2"x11 1/4"	2x12
L5	3	38x286mm	1 1/2"x11 1/4"	2x12

GLUE-LAMINATED LINTELS

L6	3	44x302mm	1 3/4"x11 7/8"	LVL
----	---	----------	----------------	-----

LINTEL NOTES

- INSTALL WOOD LINTELS WITH EVEN, LEVEL & SOLID BEARING AT END SUPPORTS. LENGTH OF END BEARING SHALL BE NOT LESS THAN 38mm OR 1 1/2" MIN. AT EACH SUPPORT, UNLESS NOTED OTHERWISE ON DRAWINGS.
- SEPARATE WOOD LINTEL MEMBERS WITH FILLER PIECES TO MATCH WIDTH OF WALL FRAMING WHERE LINTEL IS LOCATED.
- INSTALL GLUE-LAMINATED ENGINEERED WOOD LINTELS WITH EVEN, LEVEL & SOLID BEARING AT END SUPPORTS. LENGTH OF END BEARING SHALL BE NOT LESS THAN 76mm OR 3" AT EACH SUPPORT.

FLOOR PLAN LEGEND

- EX DENOTES EXISTING
- EXISTING WALL, PARTITION, OR COLUMN TO REMAIN
- NEW WALL, PARTITION, OR CORE ELEMENT
- HOSE BIB, NON-FREEZE TYPE
- GAS METER
- ELECTRICAL METER
- ELECTRICAL PANEL
- DUPLEX RECEPTACLE, 110 VOLT
42=NON-STANDARD MOUNTING HEIGHT
CM=CASEWORK-MOUNTED
FM=FLOOR-MOUNTED IN BOX
CFI=GROUND FAULT INTERRUPTED
Q=QUAD RECEPTACLE
WP=WEATHER-PROOF BOX

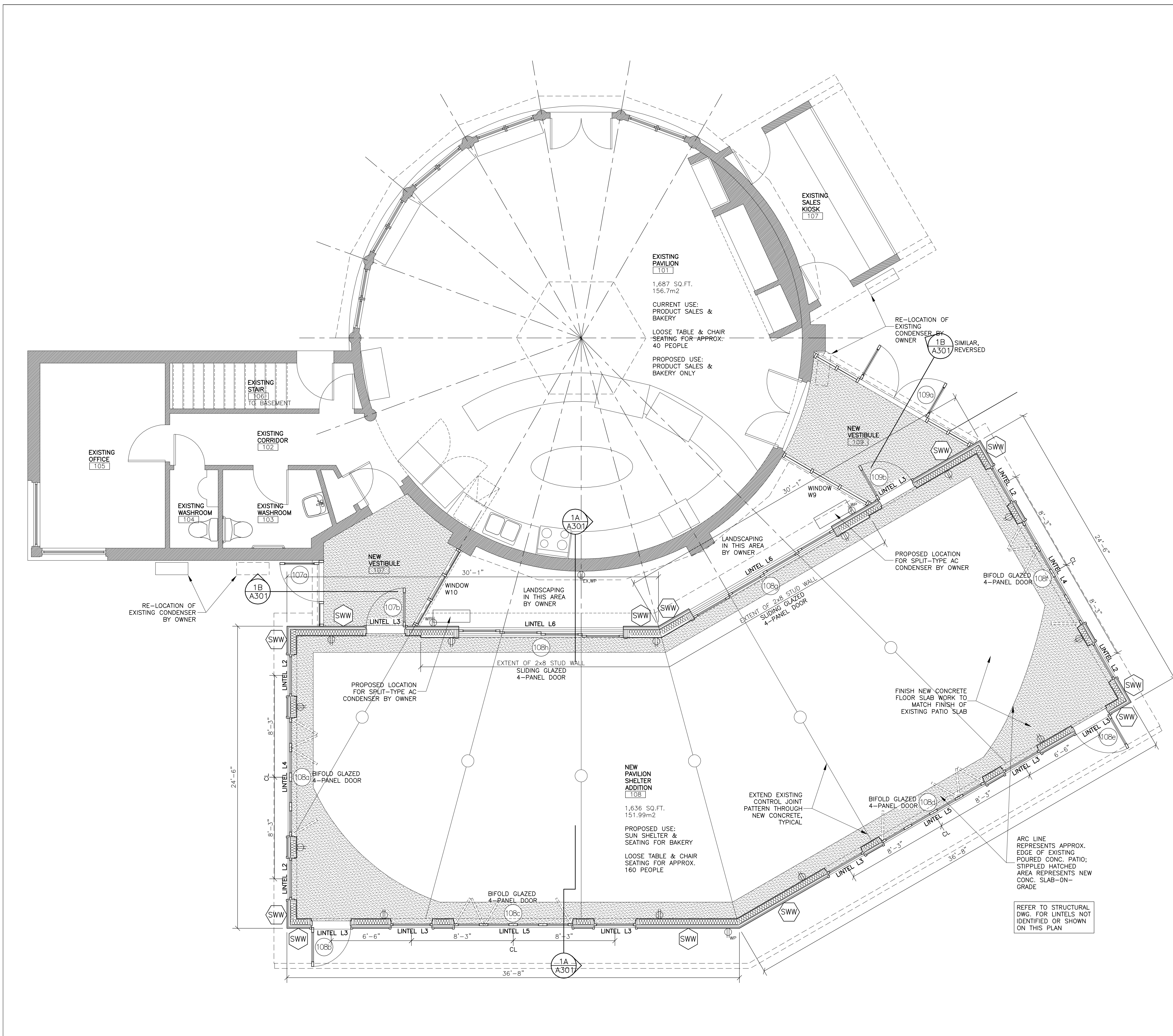

1 GROUND FLOOR PLAN
SCALE: 1/4"=1'-0"

ADDITION TO THE BLUEBERRY PAVILION

WILMOT ORCHARDS
3377 CONCESSION ROAD 3
CLARINGTON, ON L1B 0N1

SHEET TITLE:

GROUND FLOOR PLAN

DRAWN BY: RP
PROJECT NO: 19.316
CHK'D BY: RP
DATE: MAY 2019

A103



148 WALTON STREET, PORT HOPE, ONTARIO L1A 1N6, CANADA
TEL: (905) 885-8729 www.picciniarchitect.net

THESE DRAWINGS, DETAILS AND SPECIFICATIONS ARE A CONFIDENTIAL AND PROPRIETARY WORK. PROTECTED UNDER COPYRIGHT. ALL RIGHTS ARE RESERVED. THEY ARE THE PROPERTY OF PICCINI ARCHITECT AND MAY NOT BE REPRODUCED BY ANY MEANS, ALTERED OR RE-USED WITHOUT THE EXPRESS WRITTEN PERMISSION OF PICCINI ARCHITECT

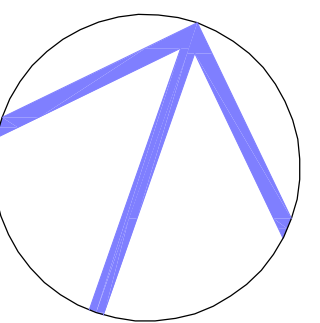

THESE DRAWINGS, DETAILS AND SPECIFICATIONS ARE NOT TO BE USED FOR CONSTRUCTION UNTIL COUNTER-SIGNED BY THE ARCHITECT

NO.	DATE	ISSUE/REVISION FOR:	BY:
	D.M.Y.		
1	14.01.20	CLIENT REVIEW	R.P.
2	13.02.20	BUILDING PERMIT	R.P.
3	14.05.20	TENDER	R.P.

SELECTIVE DEMOLITION NOTES

SELECTIVE DEMOLITION

- PROTECT AREA SURROUNDING SELECTIVE DEMOLITION FROM DAMAGE FROM FALLING DEBRIS & OTHER CAUSES. PERFORM WORK IN ACCORDANCE WITH CSA S350-M, CODE OF PRACTICE FOR SAFETY IN DEMOLITION OF STRUCTURES.
- BRACE LOAD-BEARING ELEMENTS TO ENSURE WORK AT NO TIME IS IN DANGER OF COLLAPSING OR ENDANGERING SAFETY OF WORKERS OR BUILDING OCCUPANTS.
- REMOVE CAREFULLY THE FOLLOWING ITEMS & TURN OVER TO OWNER:
-SIX 4"x8" WOOD BEAMS
- REMOVE EXISTING CONCRETE COLUMNS & PORTIONS OF PATIO SLAB AS SHOWN ON DRAWINGS. CUT COLUMNS FLUSH WITH ADJACENT PATIO SURFACE, TAKING CARE NOT TO DAMAGE EXISTING CONCRETE PATIO SURFACE. PROVIDE SURFACE PROTECTION AS REQUIRED.
- DEMOLISH COLUMNS & TRELLIS STRUCTURE IN SMALL PORTIONS. CUT PATIO SLAB STRAIGHT WITH POWER DRIVEN ABRASIVE CUTTING DISC. WET DOWN AREA TO KEEP DUST EMISSIONS TO MINIMUM. PREVENT DUST FROM MIGRATING BEYOND WORK AREA INTO EXISTING BUILDING.
- REPAIR & MAKE GOOD DAMAGE TO EXISTING FINISHES & SUBSTRATES CAUSED DURING PERFORMANCE OF DEMOLITION WORK.
- REMOVE & DISPOSE OF DEMOLITION DEBRIS UNLESS NOTED OTHERWISE.

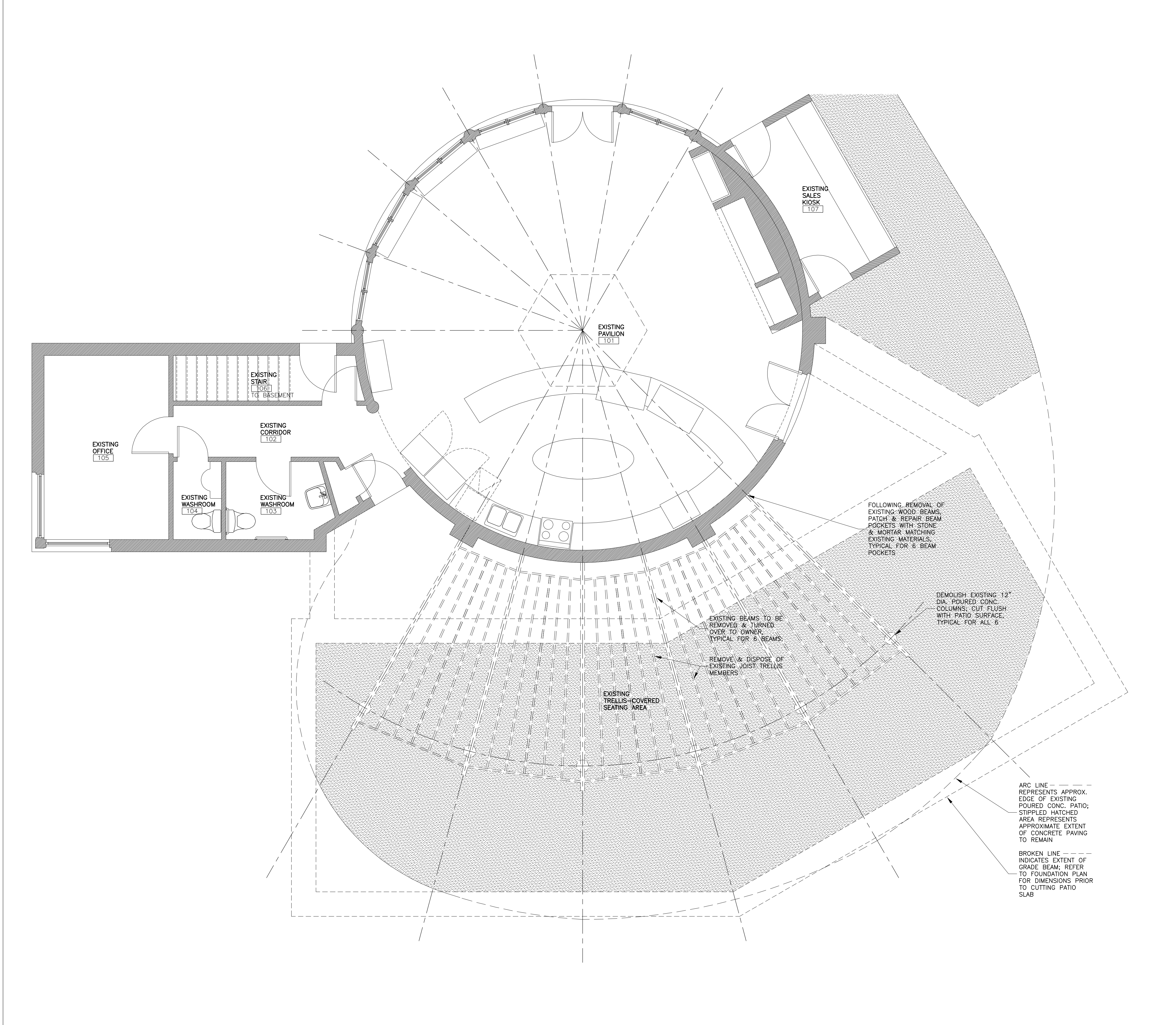

1 DEMOLITION PLAN
A105 SCALE: 1/4"=1'-0"

ADDITION TO THE BLUEBERRY PAVILION

WILMOT ORCHARDS
3377 CONCESSION ROAD 3
CLARINGTON, ON L1B 0N1

SHEET TITLE:

SELECTIVE DEMOLITION PLAN

DRAWN BY: RP	CHK'D BY: RP
PROJECT NO: 19.316	DATE: MAY 2019

A105

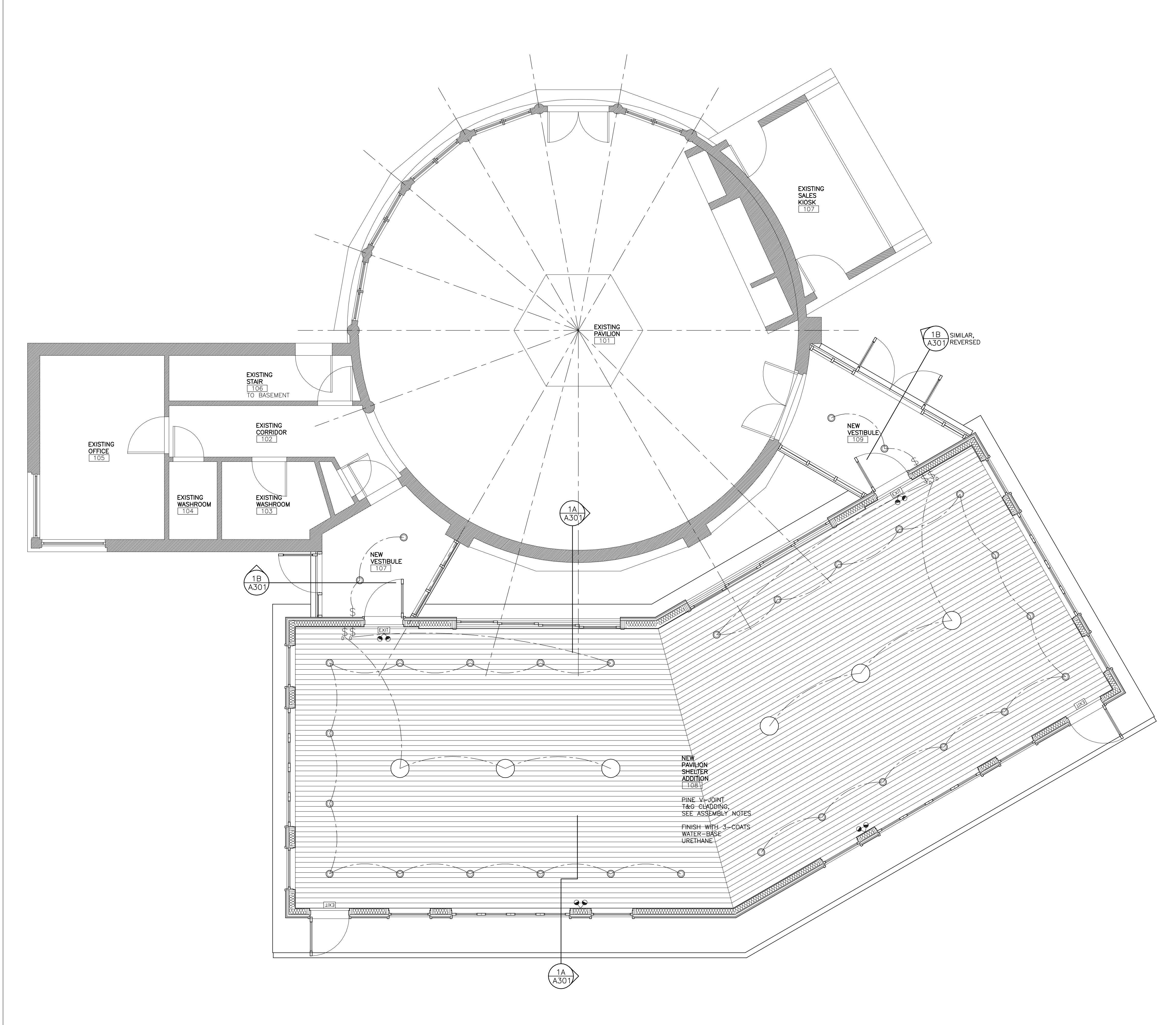

CEILING PLAN NOTES

- 1 SUPPLY & INSTALL MATERIALS, FINISHES & ELECTRICAL FIXTURES SHOWN ON REFLECTED CEILING PLANS, UNLESS NOTED OTHERWISE.
 - 2 SUBMIT SAMPLES OF MATERIALS & FINISHES TO ARCHITECT FOR APPROVAL PRIOR TO PROCURING & COMMENCING WORK.
 - 3 INSTALL & APPLY ALL MATERIALS & FINISHES IN STRICT COMPLIANCE WITH MANUFACTURER'S INSTRUCTIONS.
- ELECTRICAL**
- 1 PERFORM WORK IN ACCORDANCE WITH ELECTRICAL SAFETY CODE, CURRENT EDITION, BASED UPON CANADIAN ELECTRICAL CODE, PART 1, CSA STANDARD C22.1 & ALL BULLETINS ISSUED TO DATE.
 - 2 OBTAIN ESA INSTALLATION PERMIT PRIOR TO COMMENCING WORK ON SITE, & ARRANGE FOR ESA INSPECTIONS OF WORK.
 - 3 PROVIDE CSA APPROVED MATERIALS ONLY.
 - 4 PROVIDE NEW LIGHT FIXTURES IN QUANTITY & LOCATIONS AS SHOWN ON REFLECTED CEILING PLAN, & INSTALL FIXTURES SCHEDULED TO BE SUPPLIED BY OWNER.
 - 5 ALL SWITCHES & FACE PLATES ARE TO BE IN "DECORA" STYLE, COLOUR TO BE SELECTED BY OWNER.
 - 6 WALL MOUNT LIGHT SWITCHES 46" ABOVE FINISHED FLOOR. WHEN GROUPING DEVICES, ENSURE EQUAL SPACING VERTICALLY & AN EVEN LINE HORIZONTALLY, GANG BOXES & COVER PLATES WHERE POSSIBLE.
 - 7 PERFORM TESTING OF SYSTEMS AS REQUIRED BY CODE. AT COMPLETION OF WORK, FORWARD COPY OF ESA CERTIFICATES OF ACCEPTANCE TO ARCHITECT.



148 WALTON STREET, PORT HOPE, ONTARIO L1A 1N6, CANADA
TEL: (905) 885-8729 www.picciniarchitect.net

THESE DRAWINGS, DETAILS AND SPECIFICATIONS ARE A CONFIDENTIAL AND PROPRIETARY WORK PROTECTED UNDER COPYRIGHT. ALL RIGHTS ARE RESERVED. THEY ARE THE PROPERTY OF PICCINI ARCHITECT AND MAY NOT BE REPRODUCED BY ANY MEANS, ALTERED OR RE-USED WITHOUT THE EXPRESS WRITTEN PERMISSION OF PICCINI ARCHITECT

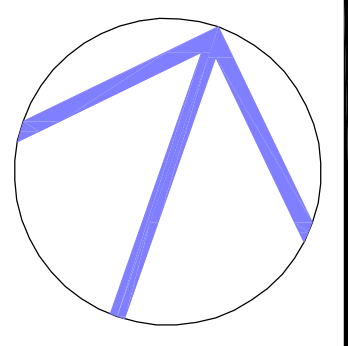

THESE DRAWINGS, DETAILS AND SPECIFICATIONS ARE NOT TO BE USED FOR CONSTRUCTION UNTIL COUNTER-SIGNED BY THE ARCHITECT

NO.	DATE:	ISSUE/REVISION FOR:	BY:
	D.M.Y.		
1	13.02.20	BUILDING PERMIT	R.P.
2	14.05.20	TENDER	R.P.

CEILING PLAN LEGEND

- EX DENOTES EXISTING
- EXISTING WALL, PARTITION, OR COLUMN TO REMAIN
- NEW WALL, PARTITION, OR CORE ELEMENT
- HOSE BIB, NON-FREEZE TYPE
- GAS METER
- ELECTRICAL METER
- ELECTRICAL PANEL
- DUPLEX RECEPTACLE, 110 VOLT
42=NON-STANDARD MOUNTING HEIGHT
CM=CASEWORK-MOUNTED
FM=FLOOR-MOUNTED IN BOX
GFI=GROUND FAULT INTERRUPTED
Q=QUAD RECEPTACLE
WP=WEATHER-PROOF BOX
- LIGHT FIXTURE, PENDANT TYPE, 120V, SUPPLIED BY OWNER
- LIGHT FIXTURE, FLUSH MOUNT TYPE, LED 3000K, 120V, THIN LINE DOWN LIGHT, 6.85" DIA., BY MAGICLITE
- SWITCH, SINGLE POLE, WALL-MOUNTED, 3=3 WAY, 4=4 WAY
D=WITH DIMMER CONTROL
K=KEY OPERATED SWITCH
M=WITH MOTION SENSOR
P=WITH PILOT LIGHT
- EXIT SIGN, ILLUMINATED 120V, WITH RUNNING SYMBOL
- EMERGENCY LIGHT, SINGLE OR DOUBLE HEAD AS SHOWN, CEILING OR WALL-MOUNTED

ADDITION TO THE BLUEBERRY PAVILION

WILMOT ORCHARDS
3377 CONCESSION ROAD 3
CLARINGTON, ON L1B 0N1

SHEET TITLE:

REFLECTED CEILING PLAN

DRAWN BY: RP	CHK'D BY: RP
PROJECT NO: 19.316	DATE: MAY 2019

A106

1 REFLECTED CEILING PLAN
SCALE: 1/4"=1'-0"

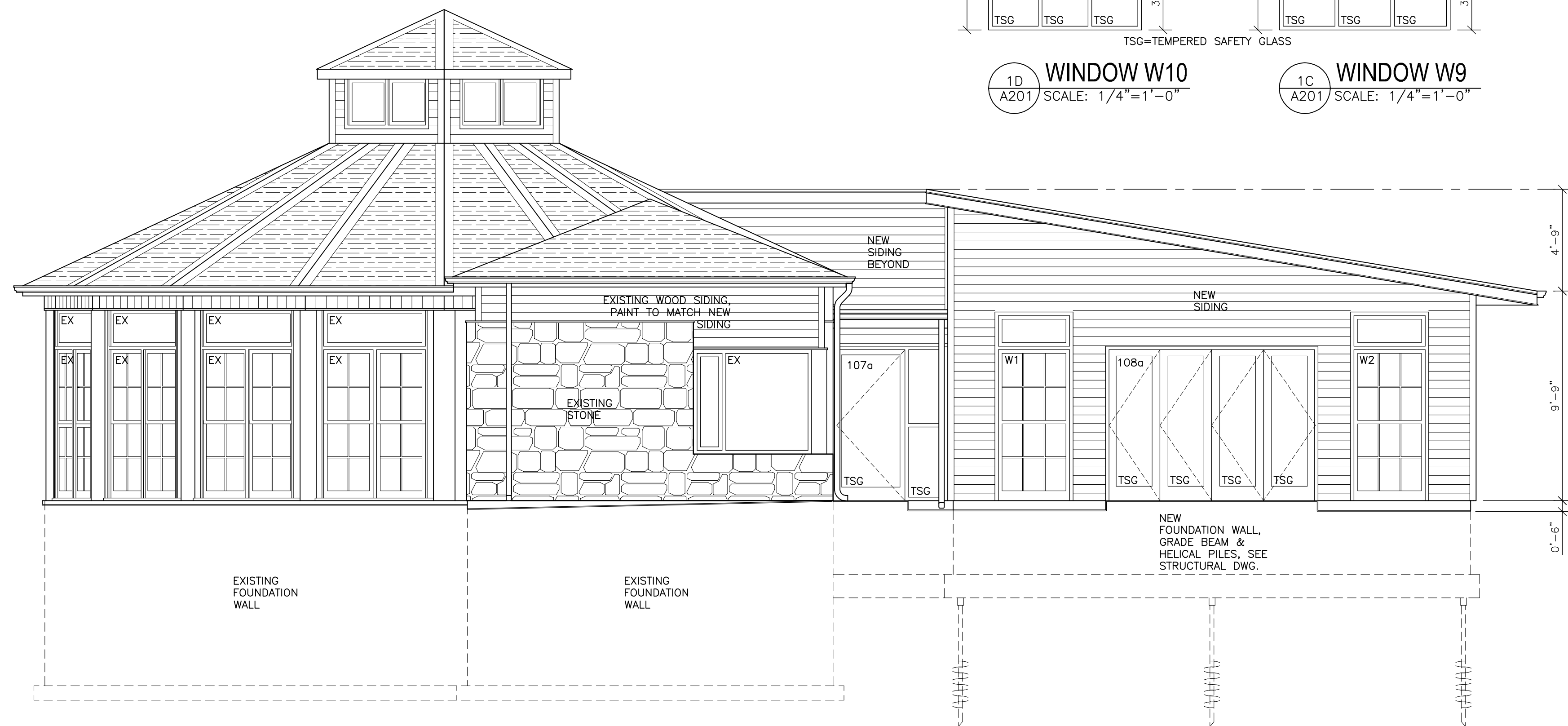

1B WEST ELEVATION
A201 SCALE: 1/4"=1'-0"

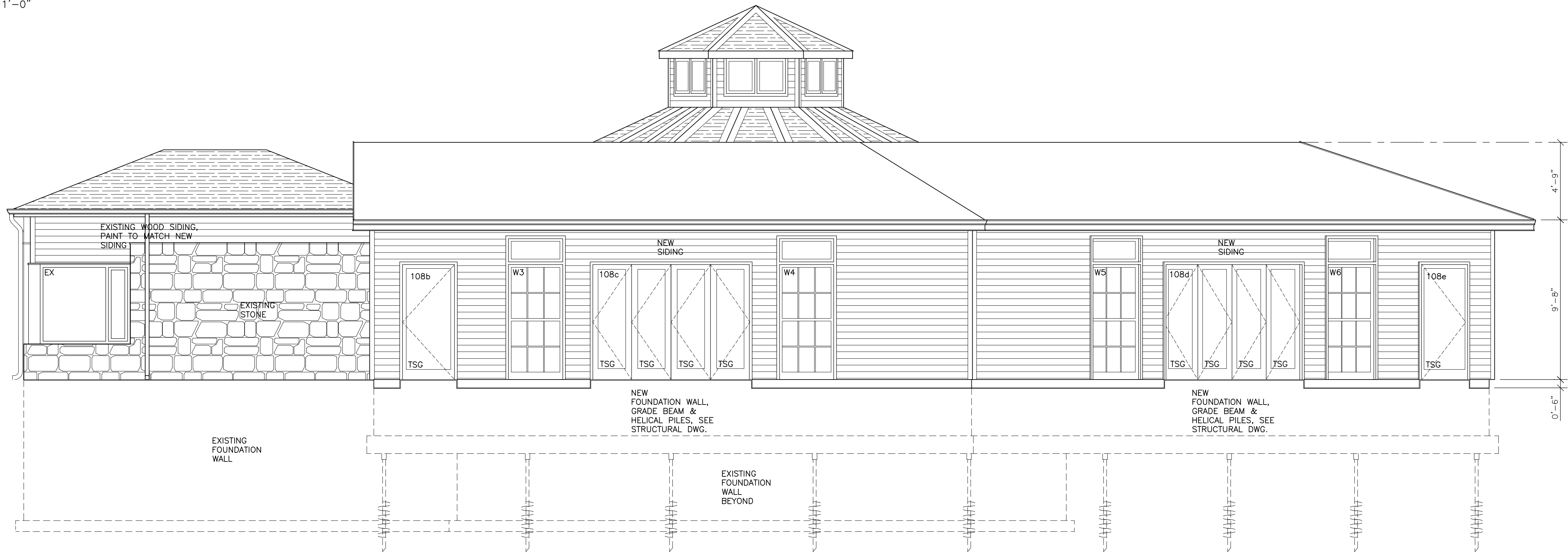

1A SOUTH ELEVATION
A201 SCALE: 1/4"=1'-0"

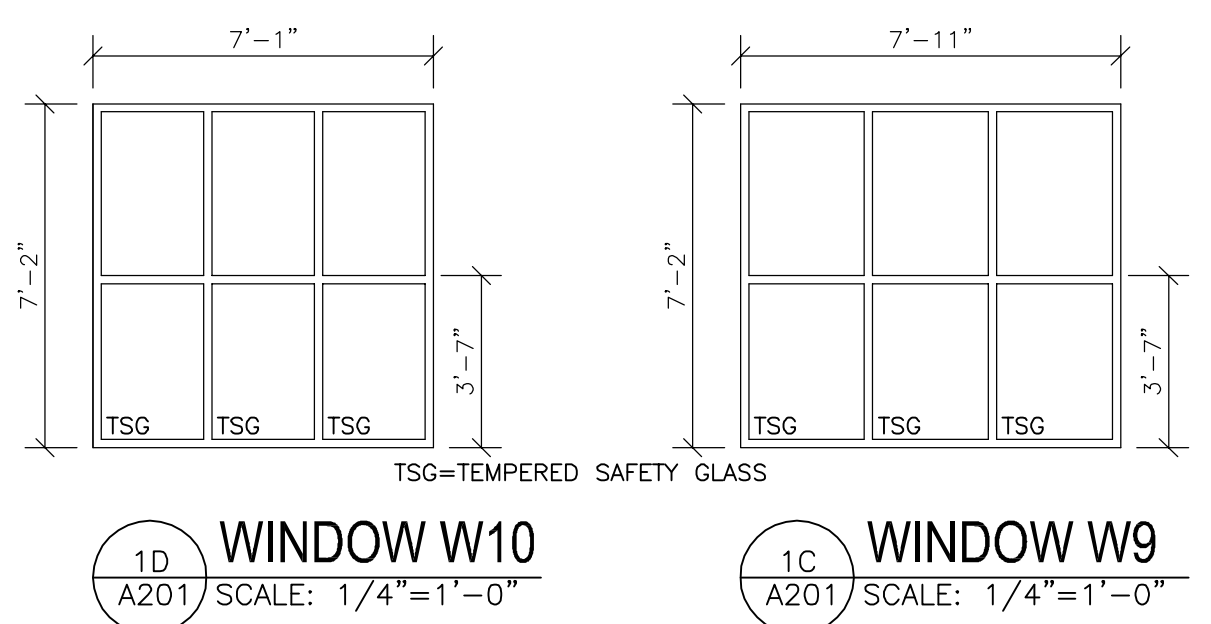

1D WINDOW W10
A201 SCALE: 1/4"=1'-0"

1C WINDOW W9
A201 SCALE: 1/4"=1'-0"

DOOR SCHEDULE														
DOOR		SIZE				FRAME				REMARKS				
NO.	TYPE	MATERIAL	FIN.	GRILLE SIZE	GLASS SIZE	WIDTH	HEIGHT	TH.	TYPE	MATERIAL	FIN.	RATING	H.G.	
GROUND FLOOR														
													COLOUR OF ALUM. DOORS, FRAMES & EXTRUDED ALUM. CLADDING TO BE SELECTED BY OWNER.	
107a	A	ALUM.	P	-	-	38"	84"	1.7"	A	ALUM.	P	-	-	SINGLE DOOR WITH SIDELIGHT, TEMPERED SAFETY GLASS, PANIC EXIT DEVICE, WEATHER STRIPPING.
107b 108e	A	ALUM.	P	-	-	38"	84"	1.7"	B	ALUM.	P	-	-	DOUBLE INSULATING TEMPERED SAFETY GLASS, LOW-E, ARGON GAS, PANIC EXIT DEVICE, WEATHER STRIPPING.
108a 108c 108d 108f	A	WOOD ALUM.-CLAD	P	-	-	115" 4 PANEL	84"	1.7"	B	WOOD ALUM.-CLAD	P	-	-	DOUBLE INSULATING TEMPERED SAFETY GLASS, LOW-E, ARGON GAS, MULTI-POINT LOCKING, FLUSH BOLTS, KEYED-ALIKE LOCKS, WEATHER STRIPPING.
108g 108h	A	WOOD ALUM.-CLAD	P	-	-	160" 4 PANEL	84"	1.7"	B	WOOD ALUM.-CLAD	P	-	-	DOUBLE INSULATING TEMPERED SAFETY GLASS, LOW-3, ARGON GAS, MULTI-POINT LOCKING, FLUSH BOLTS, KEYED-ALIKE LOCKS, WEATHER STRIPPING.
109a	A	ALUM.	P	-	-	38" PAIR	84"	1.7"	B	ALUM.	P	-	-	2 DOORS WITH SIDELIGHTS, TEMPERED SAFETY GLASS, PANIC EXIT DEVICE, WEATHER STRIPPING, AUTOMATIC DOOR OPENER.
109b	A	ALUM.	P	-	-	38"	84"	1.7"	B	ALUM.	P	-	-	DOUBLE INSULATING TEMPERED SAFETY GLASS, LOW-E, ARGON GAS, PANIC EXIT DEVICE, WEATHER STRIPPING, AUTOMATIC DOOR OPENER.

WINDOW SCHEDULE				
NO.	UNIT SIZE	TYPE/CONSTRUCTION	FINISH/COLOUR	REMARKS
NEW WINDOWS				
W1 W2 W3 W4 W5 W6 W7 W8	41"W x 103 3/4"H ROUGH STUD OPENING	CASEMENT WINDOW WITH TRANSOM/ALUMINUM-CLAD WOOD OR FIBERGLASS CONSTRUCTION WITH SIMULATED DIVIDED LITES	PRE-FINISHED IN STANDARD PAINT COLOUR/COLOUR TO MATCH DOOR & FRAME COLOUR	SEE ELEVATIONS & SPECIFICATIONS.
W9 W10	95"W x 86"H 85"W x 86"H	FIXED 3-PANEL WINDOW/ALUMINUM WITH TEMPERED SAFETY GLASS	PRE-FINISHED IN STANDARD POWER-COAT COLOUR/COLOUR TO BE SELECTED BY OWNER	SEE ELEVATIONS & SPECIFICATIONS.



148 WALTON STREET, PORT HOPE, ONTARIO L1A 1N6, CANADA
TEL: (905) 885-8729
www.picciniarchitect.com

THESE DRAWINGS, DETAILS AND SPECIFICATIONS ARE A CONFIDENTIAL AND PROPRIETARY WORK PROTECTED UNDER COPYRIGHT. ALL RIGHTS ARE RESERVED. THEY ARE THE PROPERTY OF PICCINI ARCHITECT AND MAY NOT BE REPRODUCED BY ANY MEANS, ALTERED OR RE-USED WITHOUT THE EXPRESS WRITTEN PERMISSION OF PICCINI ARCHITECT

THESE DRAWINGS, DETAILS AND SPECIFICATIONS ARE NOT TO BE USED FOR CONSTRUCTION UNTIL COUNTER-SIGNED BY THE ARCHITECT

NO.	DATE	ISSUE/REVISION FOR:	BY:
		D.M.Y.	
1	25.11.19	CLIENT REVIEW	R.P.
2	14.01.20	CLIENT REVIEW	R.P.
3	13.02.20	BUILDING PERMIT	R.P.
4	14.05.20	TENDER	R.P.

ADDITION TO THE BLUEBERRY PAVILION

WILMOT ORCHARDS
3377 CONCESSION ROAD 3
CLARINGTON, ON L1B 0N1

SHEET TITLE:

EXTERIOR ELEVATIONS

DRAWN BY: RP	CHK'D BY: RP
PROJECT NO: 19.316	DATE: MAY 2019

A201



148 WALTON STREET, PORT HOPE, ONTARIO L1A 1N6, CANADA
TEL: (905) 885-8729 www.picciniarchitect.net

THESE DRAWINGS, DETAILS AND SPECIFICATIONS ARE A CONFIDENTIAL AND PROPRIETARY WORK PROTECTED UNDER COPYRIGHT. ALL RIGHTS ARE RESERVED. THEY ARE THE PROPERTY OF PICCINI ARCHITECT AND MAY NOT BE REPRODUCED BY ANY MEANS, ALTERED OR RE-USED WITHOUT THE EXPRESS WRITTEN PERMISSION OF PICCINI ARCHITECT

THESE DRAWINGS, DETAILS AND SPECIFICATIONS ARE NOT TO BE USED FOR CONSTRUCTION UNTIL COUNTER-SIGNED BY THE ARCHITECT

NO.	DATE	ISSUE/REVISION FOR:	BY:
	D.M.Y.		
1	25.11.19	CLIENT REVIEW	R.P.
2	14.01.20	CLIENT REVIEW	R.P.
3	13.02.20	BUILDING PERMIT	R.P.
4	14.05.20	TENDER	R.P.

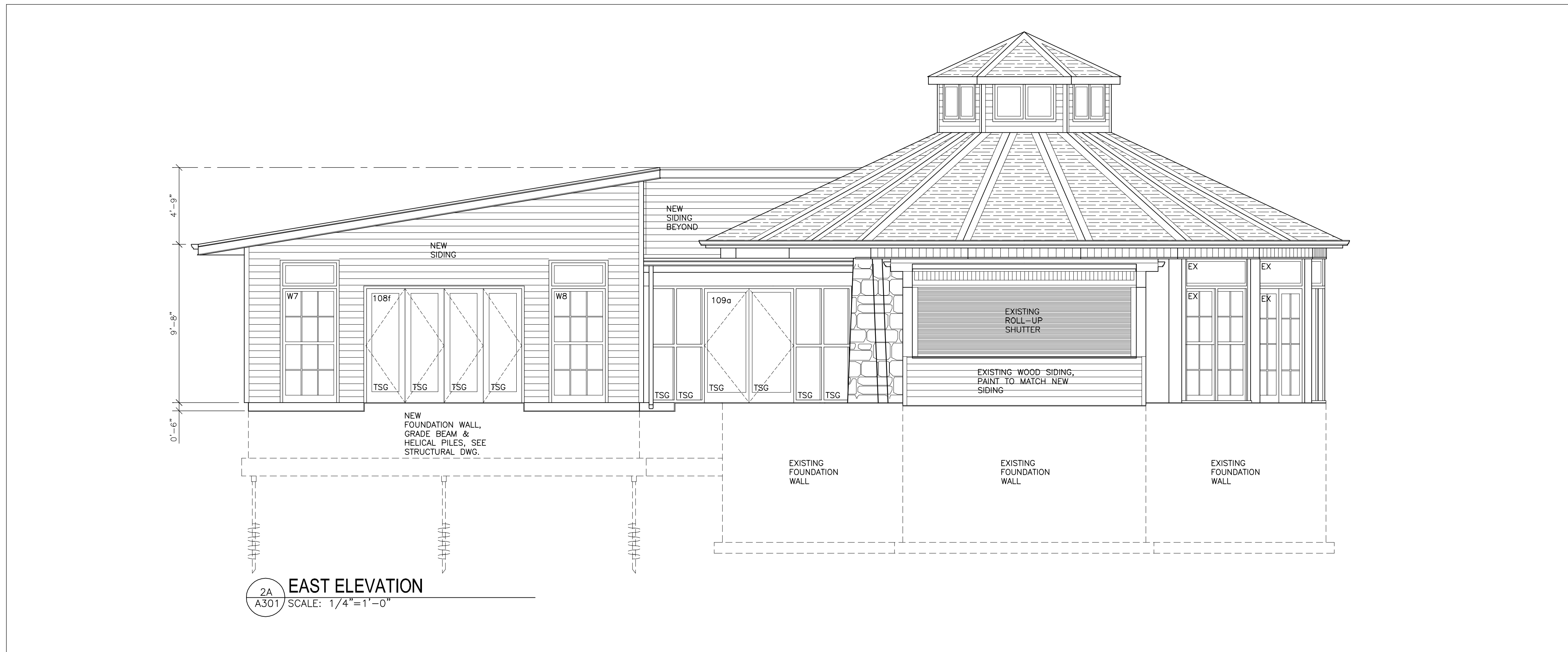

2A EAST ELEVATION
A301 SCALE: 1/4"=1'-0"

2 EXTERIOR ELEVATION
A301 SCALE: 1/4"=1'-0"

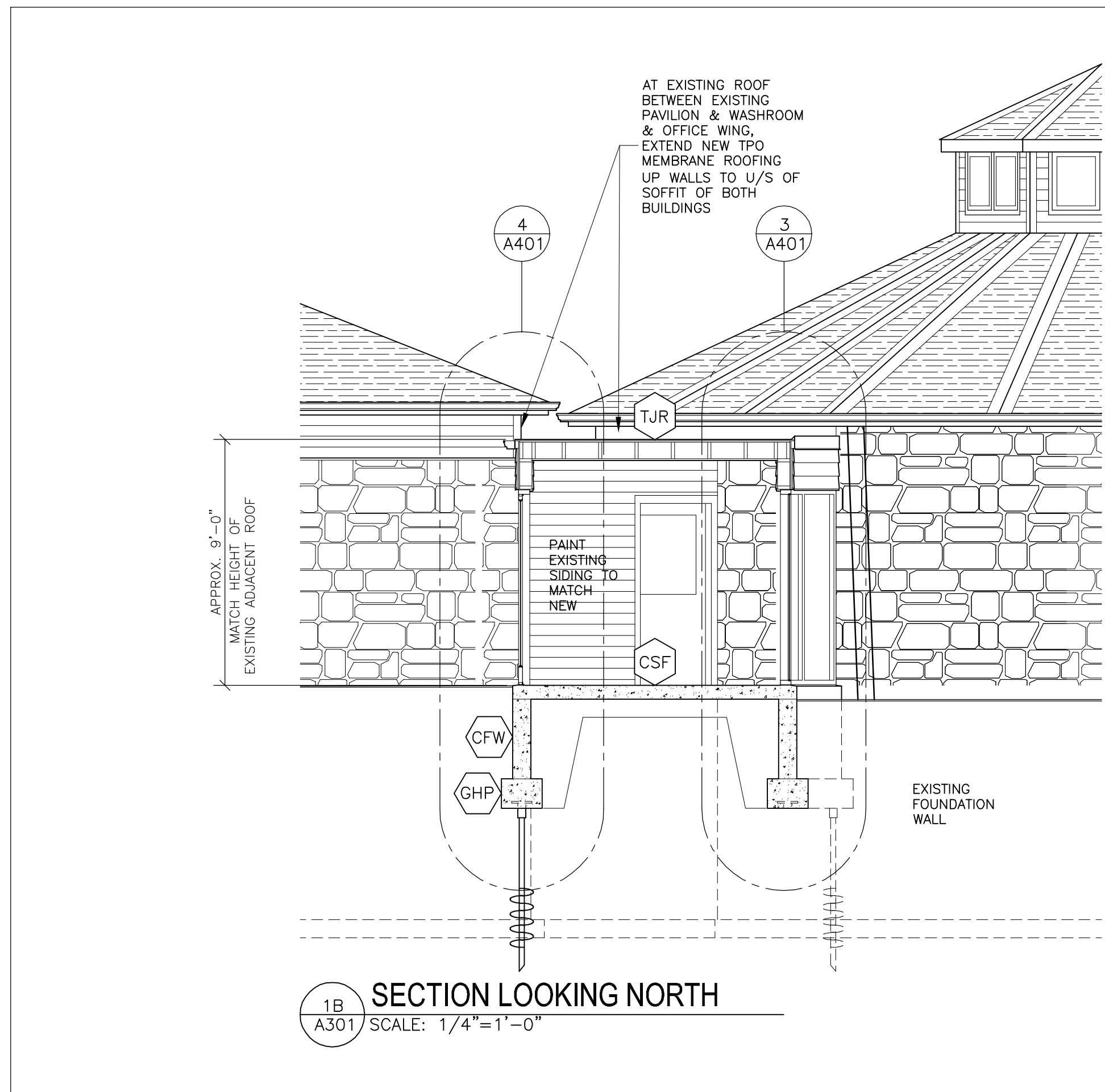

1B SECTION LOOKING NORTH
A301 SCALE: 1/4"=1'-0"

1 CROSS SECTIONS
A301 SCALE: 1/4"=1'-0"

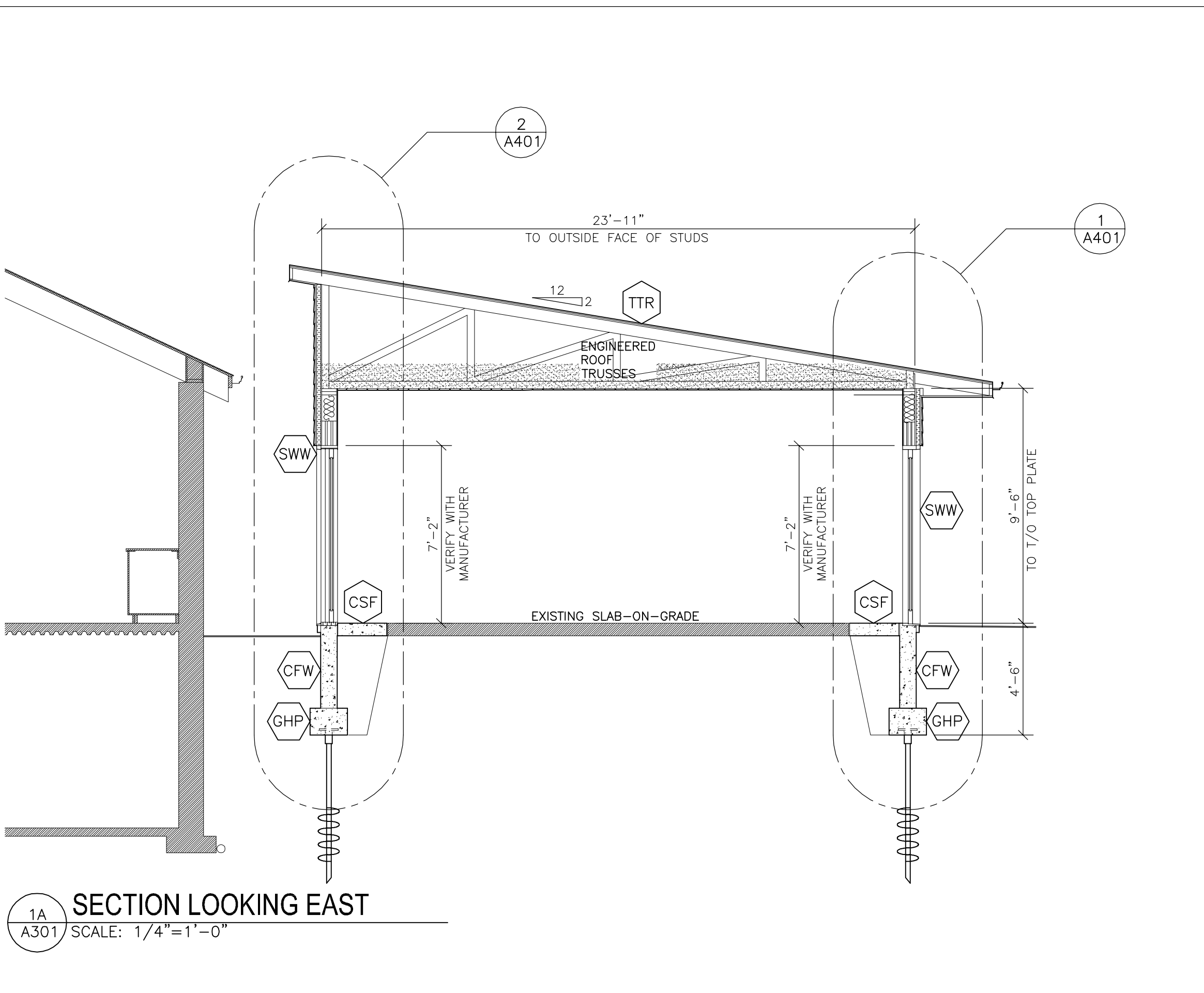

1A SECTION LOOKING EAST
A301 SCALE: 1/4"=1'-0"

ROOF ASSEMBLIES		Thermal Resistance
TPO ROOF MEMBRANE ON JOIST ROOF		
TJR	-TPO ROOFING MEMBRANE, 60mil OR 1.52mm THICK, FULLY ADHERED & MECHANICALLY FASTENED, FIRESTONE ULTRAPLY TPO, OVER COVER-BOARD SHEATHING, 1/2" OR 12.7mm THICK, ISOGARD HD BY FIRESTONE, -PLYWOOD SHEATHING, EXTERIOR GRADE T&G, 5/8" OR 16mm THICK, NAILED & GLUED, -WOOD ROOF JOISTS, SEE STRUCTURAL DWG. FOR SIZE & SPACING, -EXTERIOR GRADE GYPSUM BOARD CEILING, 1/2" OR 12.7mm THICK	
TPO ROOF MEMBRANE ON TRUSS ROOF		
TTR	-TPO ROOFING MEMBRANE, 60mil OR 1.52mm THICK, FULLY ADHERED & MECHANICALLY FASTENED, FIRESTONE ULTRAPLY TPO, OVER COVER-BOARD SHEATHING, 1/2" OR 12.7mm THICK, ISOGARD HD BY FIRESTONE, -PLYWOOD SHEATHING, EXTERIOR GRADE T&G, 5/8" OR 16mm THICK, NAILED & GLUED, -ENGINEERED WOOD ROOF TRUSSES, SEE STRUCTURAL DWGS. FOR SPACING, -CELLULOSE INSULATION, BLOW-IN, TO MIN. DEPTH TO ACHIEVE R VALUE EQUAL TO 38, -POLYETHYLENE AIR/VAPOUR BARRIER, MIN. 0.006" OR 0.15mm THICK, ALL JOINTS TAPED, -PINE T&G V-JOINT CLAD CEILING, 3/4" THICK WITH 5" EXPOSURE, NO. 1 & 2 GRADE.	2.50 0.78 38.00 1.05
	R VALUE:	42.33
	RSI VALUE:	7.45

EXTERIOR WALL ASSEMBLIES		Thermal Resistance
SIDING ON WOOD-FRAME WALL		
SWW	-PRE-FINISHED ENGINEERED WOOD LAP SIDING, 4.84" EXPOSURE, RESITECH BY MAIBEC, COLOUR TO BE CONFIRMED BY OWNER, -WOOD STRAPPING, 1x3 OR 19x64mm, SPACED VERTICALLY 16" OR 406mm OC OVER STUDS, -RIGID EPS INSULATION, WITH REFLECTIVE LAMINATION BOTH SIDES, STAGGERED LAYOUT OF 4'x8' OR 1.2x2.4m SHEETS, EDGES BUTTING TIGHTLY & JOINTS TAPED, SILVERBOARD BY ANVIC OR APPROVED EQUAL, -PLYWOOD SHEATHING, 1/2" OR 12.7mm THICK, -WOOD STUDS, 2x6 OR 38x140mm, SPACED 16" OR 406mm OC, WITH 2x6 WOOD BLOCKING AT MID HEIGHT, -FIBERGLASS BATT INSULATION, 5 1/2" OR 140mm THICK IN STUD CAVITIES, -POLYETHYLENE AIR/VAPOUR BARRIER, MIN. 0.006" OR 0.15mm THICK, LAPPED 1 STUD FRAMING MODULE WITH ALL JOINTS TAPED, -GYPSUM BOARD COVER, 1/2" OR 12.7mm THICK.	10.00 0.63 21.50 0.45
	R VALUE:	41.71
	RSI VALUE:	7.35

FLOOR ASSEMBLIES		Thermal Resistance
CONCRETE SLAB-ON-GRADE FLOOR		
CSF	-POURED CONCRETE FLOOR SLAB, MIN. 4" OR 102mm THICK, BROOM FINISH, MATCH FINISH OF EXISTING SLAB, 2900 psi OR 20 MPa COMPRESSIVE STRENGTH AFTER 28 DAYS, WITH 6x6 6/6 WELDED WIRE MESH SHEET REINFORCING AT SLAB CENTRE, -GRANULAR 1" MIN. 8" OR 200mm BASE, COMPACTED TO 98% SPMD, OVER PROOF-ROLLED NATIVE SOIL TO 20 MPa/m, ADJACENT FOUNDATION WALLS, COMPACT GRANULAR FILL IN MAXIMUM 6" OR 150mm LIFTS. SEE STRUCTURAL DWG.	

FOUNDATION ASSEMBLIES		Thermal Resistance
CONCRETE FOUNDATION WALL		
CFW	-CONCRETE FOUNDATION WALL, SEE STRUCTURAL DWG. FOR REINFORCEMENT DETAIL & CONCRETE STRENGTH.	
GRADE BEAM & HELICAL PILES		
GHP	-CONCRETE GRADE BEAM & HELICAL PILES, SEE STRUCTURAL DWG. FOR REINFORCEMENT DETAIL, CONCRETE STRENGTH & HELICAL PILE NOTES.	

ADDITION TO THE BLUEBERRY PAVILION

WILMOT ORCHARDS
3377 CONCESSION ROAD 3
CLARINGTON, ON L1B 0N1

SHEET TITLE:

SECTIONS & EXTERIOR ELEVATION

DRAWN BY: RP CHK'D BY: RP
PROJECT NO: DATE:
19.316 MAY 2019

A301



148 WALTON STREET, PORT HOPE, ONTARIO L1A 1N6, CANADA
TEL: (905) 885-8729 www.picciniarchitect.net

THESE DRAWINGS, DETAILS AND SPECIFICATIONS ARE A CONFIDENTIAL AND PROPRIETARY WORK PROTECTED UNDER COPYRIGHT. ALL RIGHTS ARE RESERVED. THEY ARE THE PROPERTY OF PICCINI ARCHITECT AND MAY NOT BE REPRODUCED BY ANY MEANS, ALTERED OR RE-USED WITHOUT THE EXPRESS WRITTEN PERMISSION OF PICCINI ARCHITECT

THESE DRAWINGS, DETAILS AND SPECIFICATIONS ARE NOT TO BE USED FOR CONSTRUCTION UNTIL COUNTER-SIGNED BY THE ARCHITECT

NO.	DATE:	ISSUE/REVISION FOR:	BY:
	D.M.Y.		
1	13.02.20	BUILDING PERMIT	R.P.
2	14.05.20	TENDER	R.P.

ADDITION TO THE BLUEBERRY PAVILION

WILMOT ORCHARDS
3377 CONCESSION ROAD 3
CLARINGTON, ON L1B 0N1

SHEET TITLE:

WALL SECTIONS & MISCELLANEOUS DETAILS

DRAWN BY: RP	CHK'D BY: RP
PROJECT NO: 19.316	DATE: MAY 2019

A401

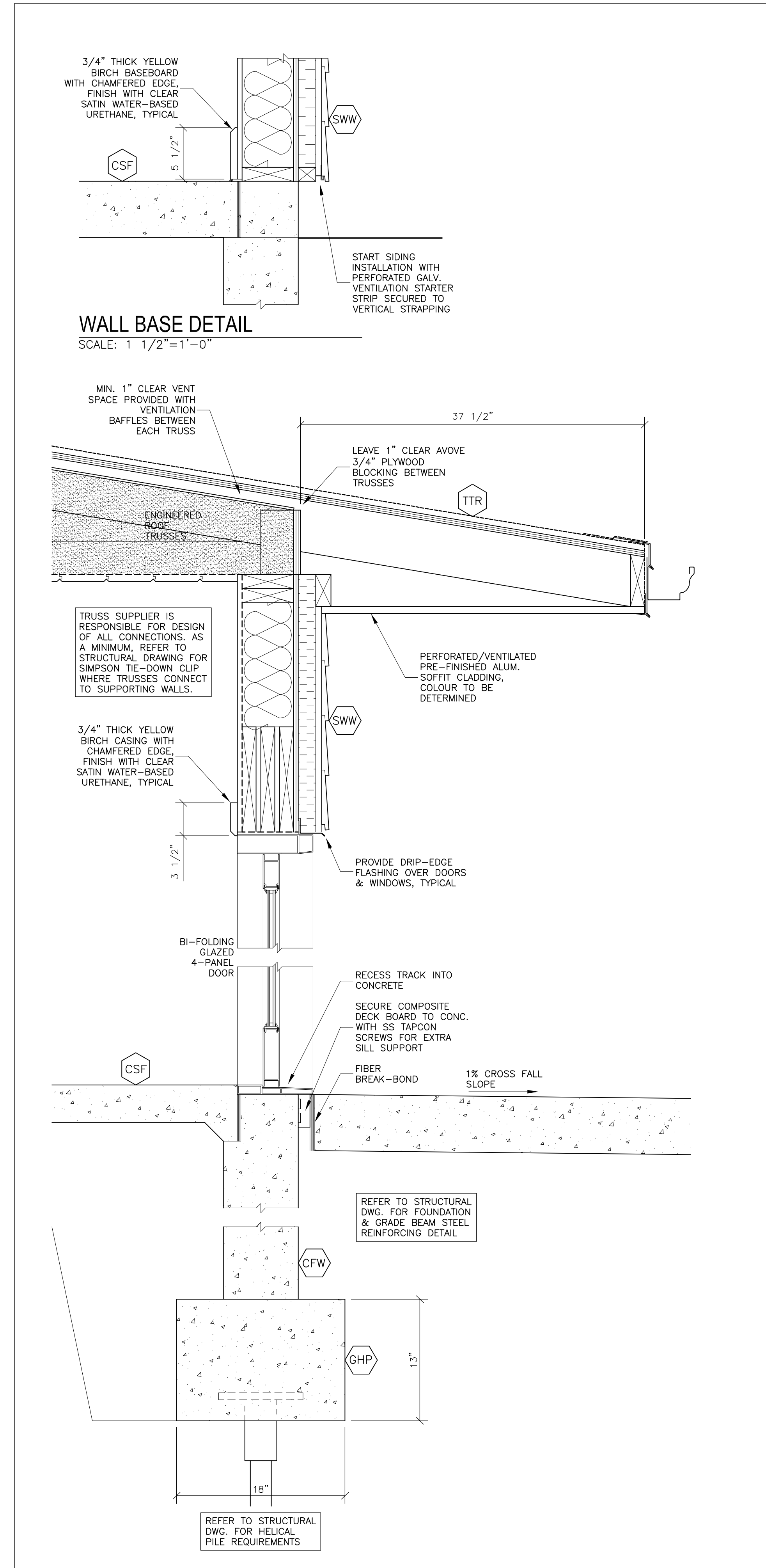

1 WALL SECTION
SCALE: 1 1/2"=1'-0"

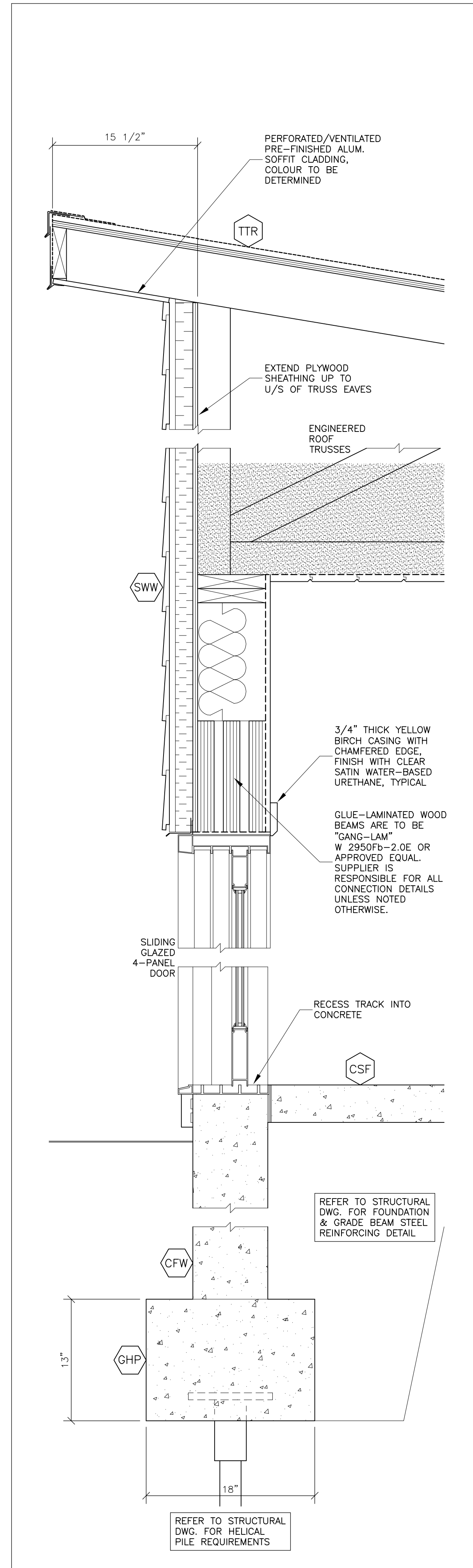

2 WALL SECTION
SCALE: 1 1/2"=1'-0"

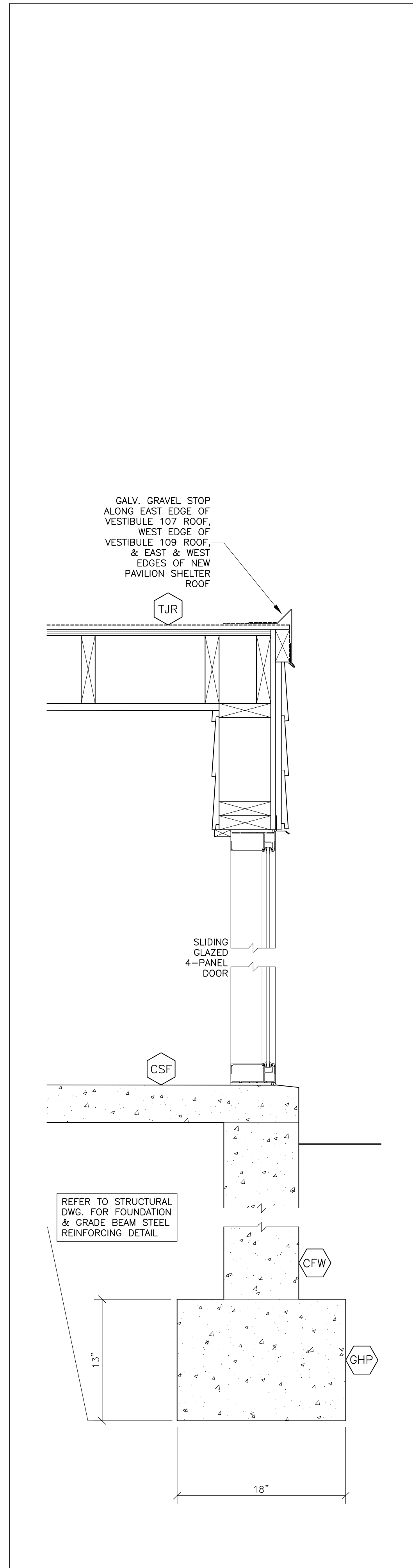

3 WALL SECTION
SCALE: 1 1/2"=1'-0"

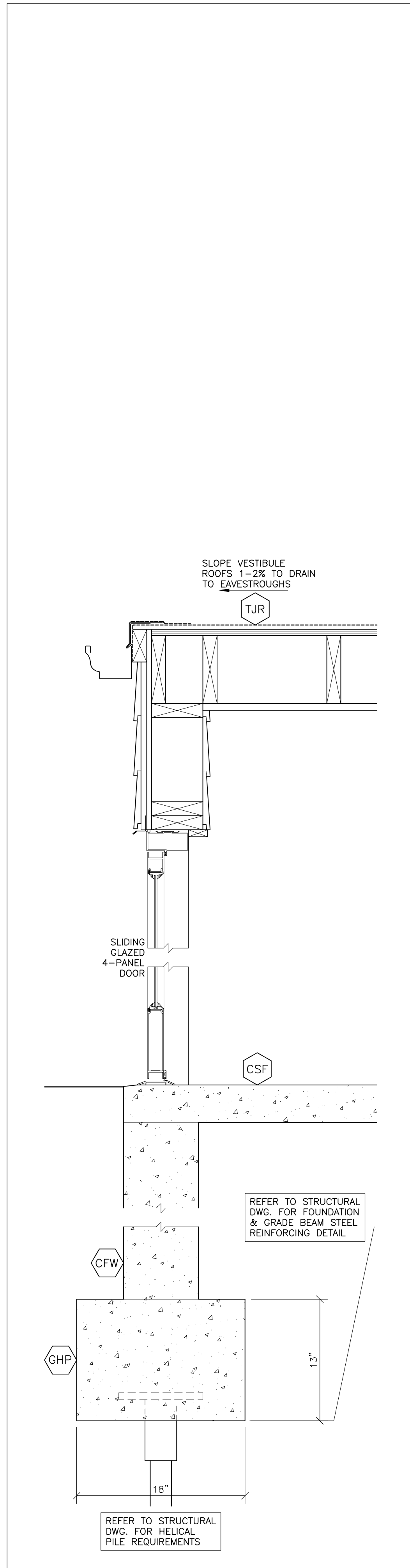

4 WALL SECTION
SCALE: 1 1/2"=1'-0"

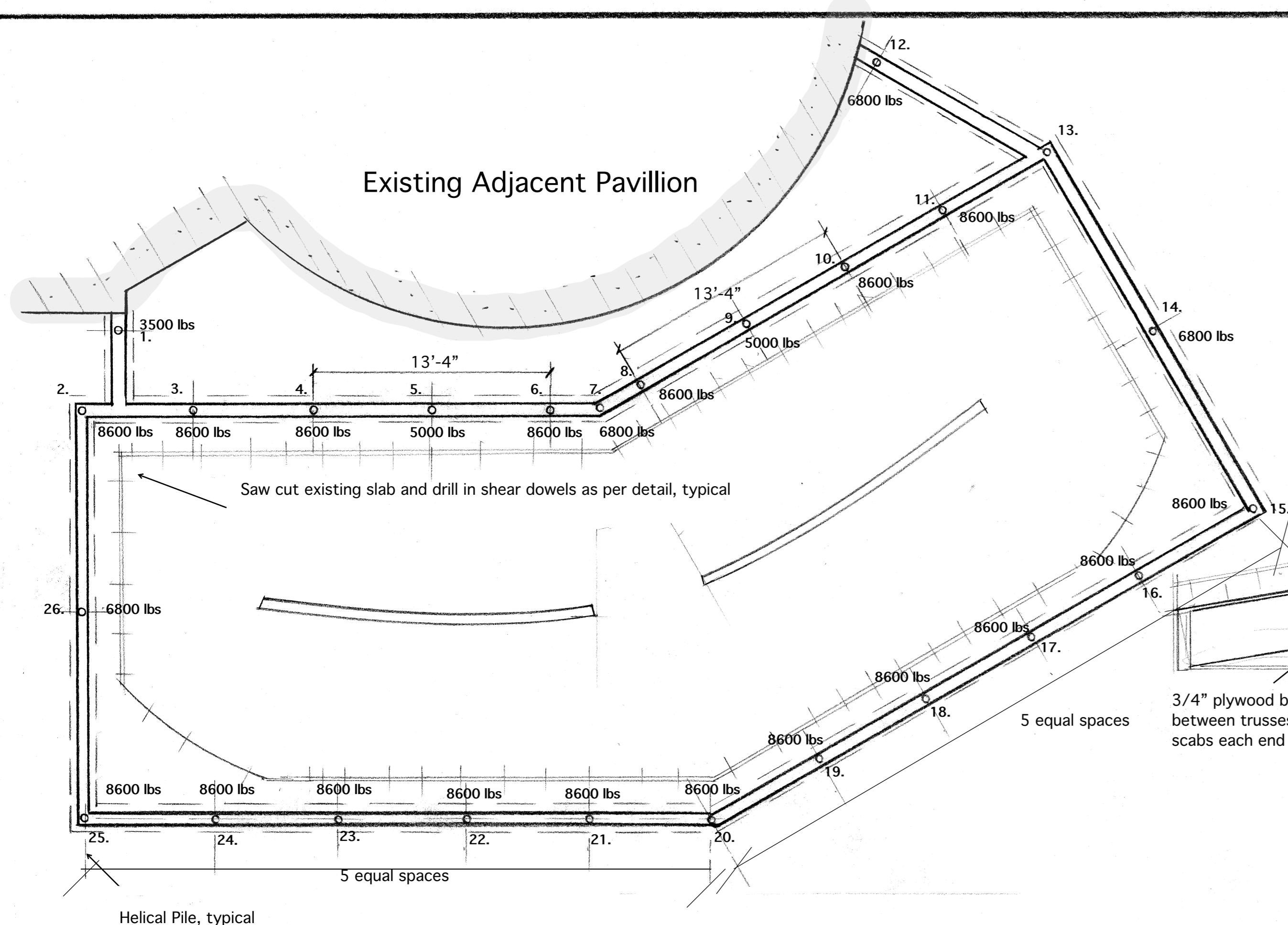

Foundation Framing Plan 1'-0" = 3/16"

All concrete to be 20MPa @ 28 days.

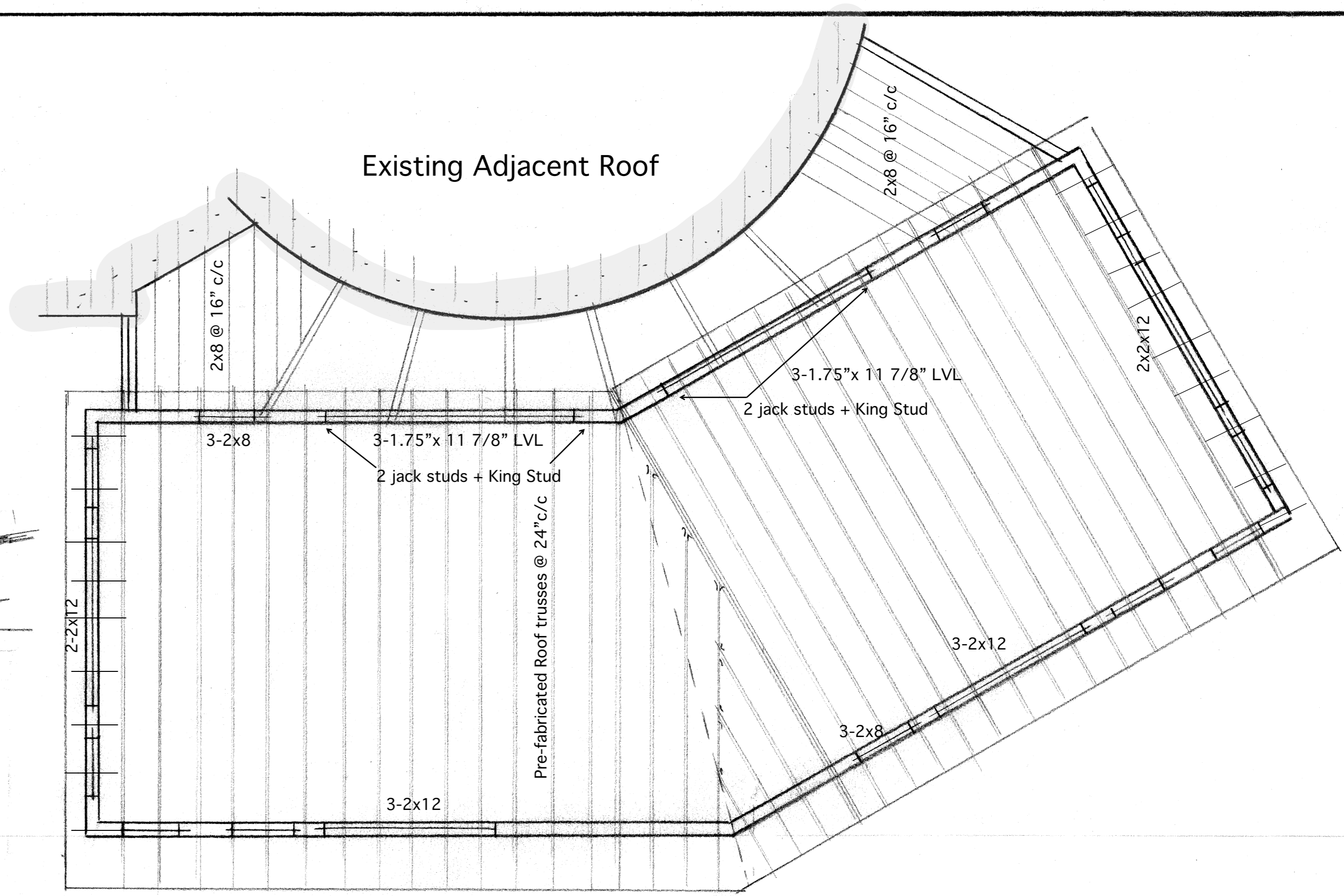

Roof Framing Plan 1'-0" = 3/16"

5/8" exterior grade plywood on Prefabricated Wood trusses @ 24" c/c
Dead load 12 psf Live (snow) load 31.7 psf

Helical Pile Notes

- 1) All helical piles to be 2 7/8" diameter with the minimum load capacity and certified resistance by a professional engineer for the specified loads as shown on drawings.
- 2) An accurate log for each helical pile, shall be kept including torque, slope, and length of each anchor.
- 3) Multiple pile groups may be substituted for single piles provided piles are no closer than 2 helix blade diameters apart and combined capacities are no less than loads indicated.

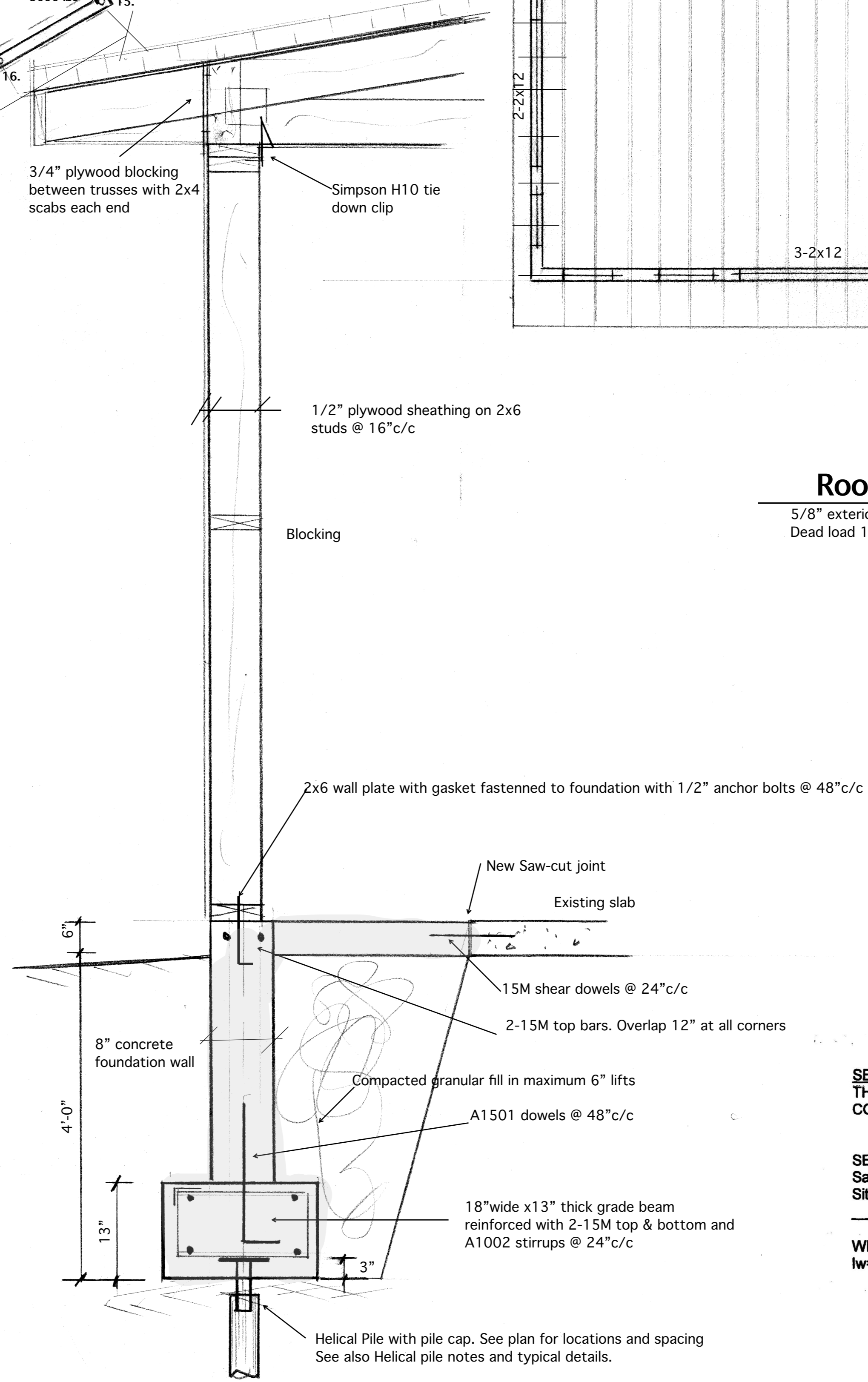
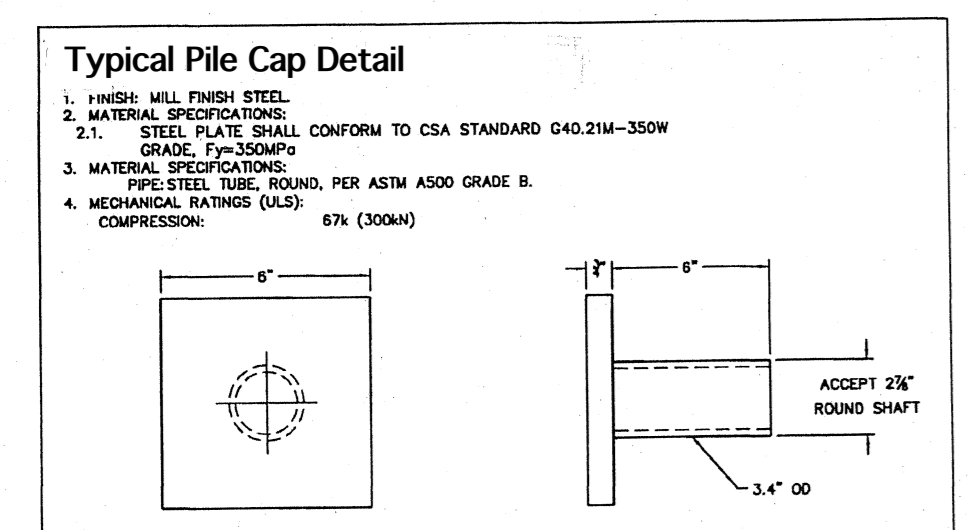

Typical Wall Section

SEISMIC AND WIND AND ROOF LOADING DESIGN
THE LATERAL FORCE RESISTING SYSTEM OF THIS BUILDING
CONSISTS OF WOOD SHEARWALLS DESIGN FOR WIND AND SEISMIC FORCES

SEISMIC (SFRS)
Sa(0.2)= 0.20 Sa(0.5)=0.13 Sa(1.0)=0.073 Sa(2.0)=0.023
Site Class: D Fa=1.3 Fv=1.4 Ie=1.0 Regular Structure, Static Analysis

WIND
Iw=1.0 q10=.74 Kpa q50=.96 Kpa

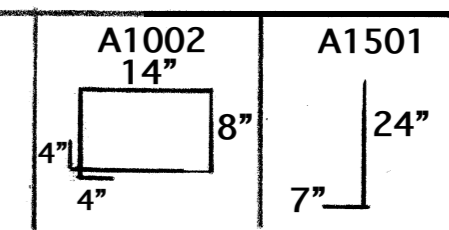

KSANDER & ASSOCIATES

STRUCTURAL CONSULTING ENGINEERS

130 HUNTER STREET
UNIT 103
PETERBOROUGH, K9H 2K8
(705) 743-9221
ksanders@bellnet.ca

THIS DRAWING SHALL NOT BE USED FOR CONSTRUCTION UNLESS COUNTERSIGNED BY THE ENGINEER

Addition to the Blueberry Pavilion
Wilmot Orchards
3377 Concession Road 3, Clarington

FOUNDATION & ROOF FRAMING PLAN

DATE: Jan.2020 SCALE: 1'-0"=3/16"

DESIGNED BY RK
CHECKED BY RK

S-1